

**SAHYADRI ELECTRO CONTROLS (I) PVT. LTD.**

**SECO**



## **EARTH LEAKAGE RELAY WITH CBCT (TYPE: SRC 100E)**

# 10, VINAY COMPLEX, 1<sup>ST</sup> CROSS, RAJGOPAL NAGAR MAIN ROAD, GANAPATHI NAGAR,  
PEENYA III PHASE, BANGALORE – INDIA - 560058

Mail: [mkt@secoindia.co.in](mailto:mkt@secoindia.co.in) & [sales@secoindia.co.in](mailto:sales@secoindia.co.in), Web: [www.secoindia.co.in](http://www.secoindia.co.in)

**SAHYADRI (SECO)** make **Earth Leakage Relay with CBCT** is designed with Microcontroller based advance technology to sense the leakage current from Insulation to ground through core balance current transformer(CBCT). When the earth leakage current is more than the set value, the output relay operates as per the set time delay. The output relay contacts are used for tripping. Output relays are self-resettable and Indications are hand resettable. This unit has application in LT panels with distribution of low load power.

**Earth leakage relays** play two very important roles in electrical system – protection of human beings from electrocution and safety from Fire. Leakage current though very small magnitude can wreak havoc in the installations. 'Short Circuit' is commonly attributed as the cause of electrical fires but actually in majority of the cases, it is the leakage current which is the primary cause of electrical fires. Earth leakage relays are used in conjunction with highly sensitive toroid CTs also known as CBCTs to perform the function of detecting these leakage currents and tripping the circuits before any mishap takes place.

## FEATURES:-

- Microcontroller based design
- With Tape wound CT's
- Wide setting range
- Test facility
- Settings through Dip switches
- Fault & Trip indications by LED
- 2 sets of output change over contacts
- 96 Sq. mm front Facia
- Low depth of 45 mm
- Suitable for flush mounting & projection mounting
- Poly carbonate front cover for protection

## TYPES OF EARTH LEAKAGE RELAYS - AVAILABLE

Sl no.	Models - Current setting
01	0.5A to 8 Amps
02	0.3 A to 3.0 Amps
03	30 mA to 3 Amps
04	30 mA & 100 mA

## TECHNICAL SPECIFICATIONS:-

- **Aux. Supply:** 110V / 230V AC 50 hz (415V is on request)
- **Current Setting range**
  - a. 0.5A to 8 A
  - b. 0.3A to 3A
  - c. 30mA to 3A
  - d. 30mA & 100 mA
- **Selectable Operating time:** Inst. 1 to 8 Sec insteps of 1 Sec
- **Output contact:** 2 sets of change over contacts (NC-C-NO)
- **Contact Rating:** 10A@24V DC or 230V AC
- **Indications:** Healthy, Faulty & Trip indication
- **Accuracy Operating value:** +/- 3%
- **Accuracy Operating Time:** +/- 3%
- **Burden on Aux. supply:** < 2.5VA
- **Front Facia:** 96 x 96mm
- **Panel Cutout:** 92 x 92 mm
- **Depth:** 45mm

Sl no.	Available CBCT's Sizes
01	100 mm
02	150mm
03	200 mm
04	250 mm
05	300 mm
06	Rectangular sizes

## Standard Compliance

- Accuracy : IEC 60255-3
- Insulation: IEC 60255-5

# WIRING AND PANEL CUTOUT DRAWING

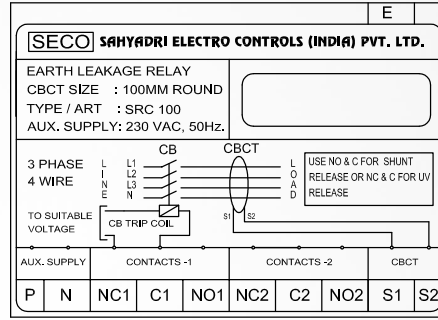
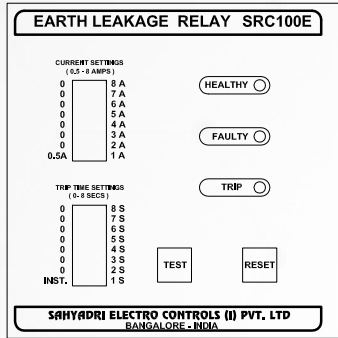

TERMINAL DETAILS

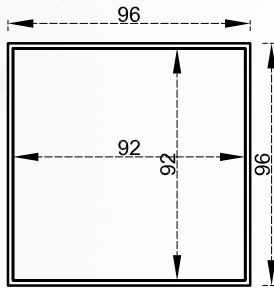

PANEL CUTOUT - 92X92 mm  
BEZZEL - 96X96 mm

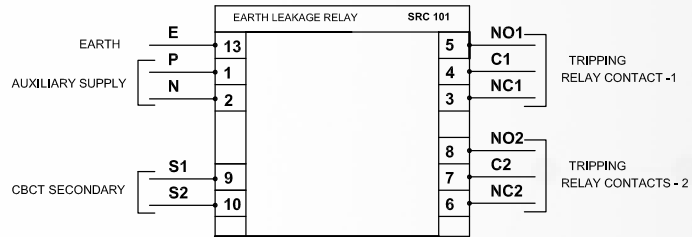

TYPICAL WIRING DIAGRAM

ALL DIMENSIONS ARE IN MM.

DRAWN BY	HSV	REV. NO.	0	ISSUED ON	01.03.12		DRAWING TITLE: APPLICATION DIAGRAM OF ELR RELAY	DRG NO.	SECO/AD/SRC101	SH.NO	01	SECO
APPD. BY	BSM			DRAWN ON	01.03.12					CONTD.	-	

**SIDE VIEW**



**BACK VIEW**

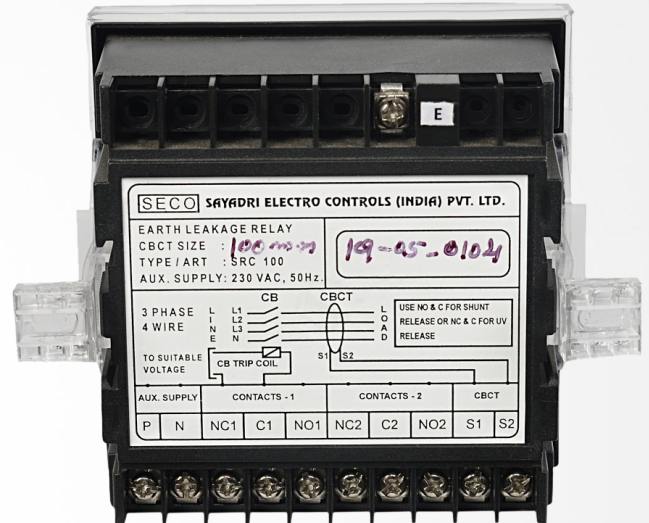

**SAHYADRI®**

ISO 9001:2015 Certified



No 10, Vinay Complex, 1st Cross, Rajgopal nagar Main Road,  
Ganapati Nagar, Peenya 3rd Phase,  
Bangalore-560058

080-4149 2637 / +91 9035048537 / +91 9448408537 / +91 9980544028

After Sales / Service : +91 9606040824

mkt@secoindia.co.in / sales@secoindia.co.in / manjunatha@secoindia.co.in